

SITE PLAN SHOWING THE LAND AREA SITUATED AT MOUZA - SULTANPUR, DAG NO. - 447, KHATAIN NO. - 256, J.L. NO. -10, R.S. NO. - 148, TOUZI NO. - 173, HOLDING NO. -26, BAKULTALA LANE, WARD NO. -7 P.S. - DUM DUM, UNDER DUM DUM MUNICIPALITY, DIST. - 24 PGS (N). KOLKATA -700028

NAME OF THE OWNER = SRI BIKASH BOSE & OTHERS
 AREA OF LAND = 5 K - 10 CH -0 SFT (376.25 sq.m)
 GROUND FLOOR COVERED AREA =239.60 sq.m. (63.68 %)
 TYPICAL FLOOR AREA =239.60 sq.m
 PERMISSABLE COVERED AREA = ~~56~~:187 %

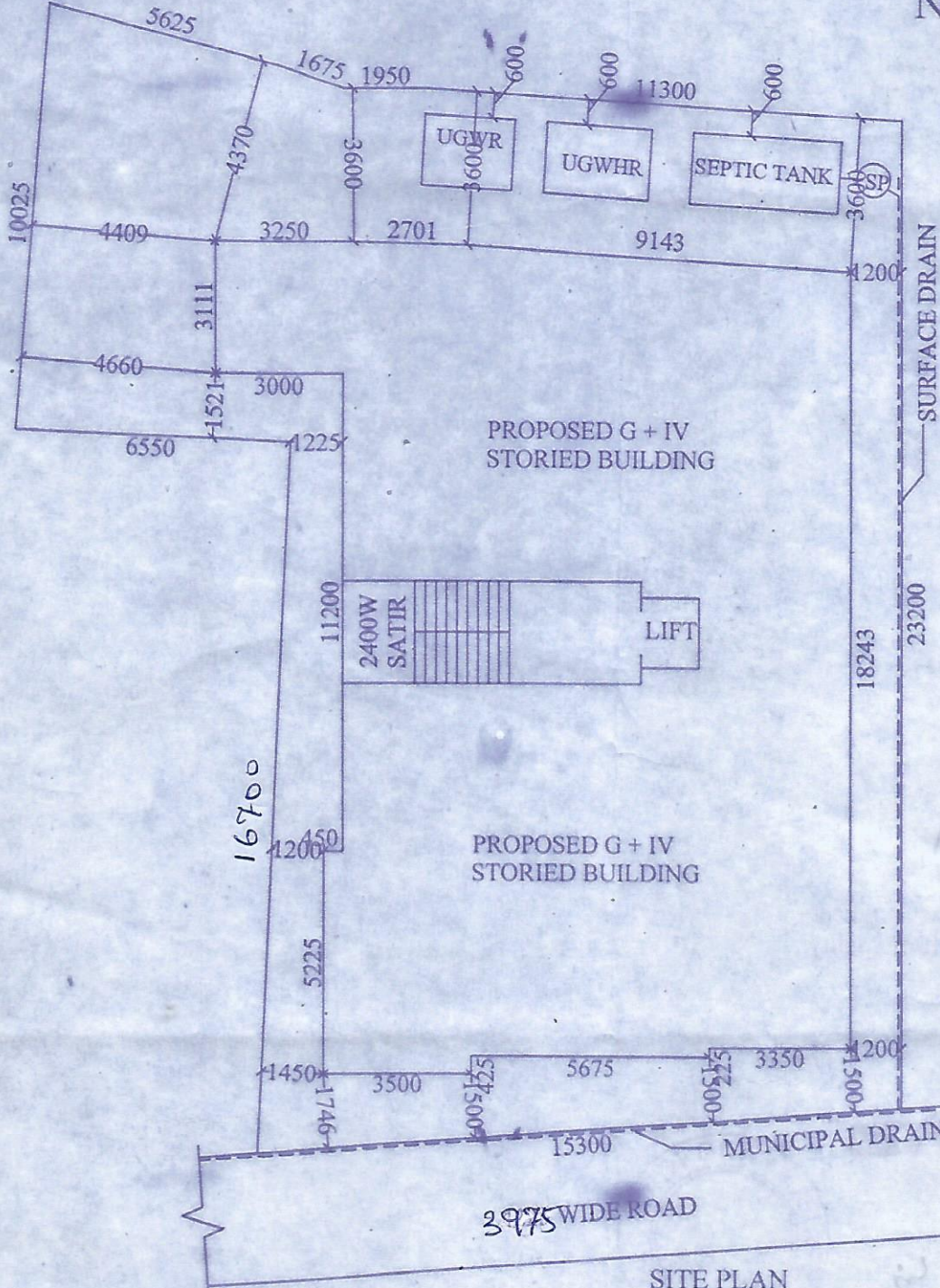

SITE PLAN

M/s. R. G. Developers and Contractor

M/s. R. G. Developers and Contractor

Jaydeb Adhya *Sekharu Sarun*

Partner Signature

Partner Signature

M/s. R. G. Developers and Contractor

Tarun Pradya

Partner Signature

Saroj Kumar Chowdhury

SAROJ KUMAR CHOWDHURY
 Civil Engineer (Dip.)
 PWD/241/B/20.19.20.20
 Dum Dum Municipality

SIGNATURE OF THE OWNER

SIGNATURE OF THE ENGINEER